

Sketchbook



ART OF DRAWERS

Table of Contents

03 Our Story

04 Our Process

05 Kitchen Design Zones

09 Custom Solutions

15 Accessories

25 Materials

29 Upgrades

33 Why Art of Drawers?





MAKING A MASTERPIECE

Solutions that Inspire

Art of Drawers creates joyful, inspirational experiences for our clients through our custom crafted creations. Each masterpiece is designed to deliver aesthetically beautiful living spaces in any room of your home. We achieve this by seamlessly merging the worlds of design and utility to give a masterpiece that is custom-tailored to suit both your needs and desires.

At Art of Drawers, we're here to help you make your home a work of art.

Our Story

With over 20 years of experience founding and building multiple consumer brands, Allan Young brought his most recent vision, Art of Drawers, to life. After creating and building the ShelfGenie Franchise System with over 160 locations in the US and Canada for the last 12 years, Allan sought to create a more elegant

and comprehensive experience for his clients. He found that working directly with his clients instead of franchising allows Art Of Drawer to deliver the highest value products and experiences. We buy our quality materials directly from US based wood manufacturers and use rails and hardware Made in America.

Your Design Artists and Artisan Craftsmen work with you to create a custom masterpiece from a palette of over 10 species of solid woods, the smoothest undermount rails in the industry, and award winning accessories. Every Art of Drawers' creation is designed to inspire and bring joy with each and every use.

Our Process

1



STEP ONE

Conception

Meet your dedicated Design Artist and start reimagining your existing kitchen.

2



STEP TWO

Creation

Collaborate with your Design Artist to create your custom masterpiece.

3



STEP THREE

Installation

Our Artisans build and install your tailor-made masterpiece with the highest level of custom craftsmanship possible.

4



STEP FOUR

Enjoyment

Look forward to being inspired every time you interact with your updated, natural and organized spaces.

5 DESIGN ZONES

Kitchen Design Zones

Make your life easier - divide your kitchen into zones!
Speak with your Design Artist about your personal or family habits so they can create workspaces arranged in a way that suits your needs. Zones create a smooth workflow and puts everything exactly where you need it.



Smooth Flow Workspaces™

When planning a kitchen, it is important to consider daily kitchen activities to make sure your kitchen is arranged in a way that will be easy to navigate. Specific storage items are used more

frequently than others. Store the items that are used daily closer to the countertop and seldomly used items in the top or very bottom level of cabinets.



Design Zones

Every kitchen can be divided into five kitchen zones - regardless of size or shape.



CONSUMABLES

Food is kept in the consumables zone. When planning this zone, it is important to ensure that everything is within easy reach.



NON-CONSUMABLES

The non-consumables zone is designed for cutlery, dishes, glasses, and plastic containers, which is why it is always a good idea to have the dishwasher close by.



CLEANING

This zone houses the dishwasher and sink. Cleaning utensils and cleaning agents should be kept here so that everything is close at hand.



PREPARATION

All the items needed for preparing food are kept in this zone. Drawers ensure that they are within easy reach.



COOKING

There should be enough space for pots, pans, lids, and cooking utensils close to the cooktop.

OUR SOLUTIONS

Custom Sketches

“The space in which we live should be for the person we are becoming now, not for the person we were in the past.”
- Marie Kondo





Cookware | Bakeware

Storing pots, pans, and countertop appliances becomes easy and elegant with Art of Drawers Pull Out Solutions. We can keep anything used for baking safe and organized using our custom shelving. Plastic containers and Tupperware can also benefit from our Solutions.

- Single Height Drawers
- Double Height Drawers



Flat Items

Cutting boards, trays, and cookie sheets can be organized and stored with ease using fully-custom Divider and Pull Out Solutions.

- Tray Bin Solution
- Divider Shelf



Under the Sink

Maximize your ability to use the space around your garbage disposal and existing plumbing using Art of Drawers' Gliding Riser and U-Shaped Solutions.

- Notched-Back Drawer
- Side Riser
- U-Shaped Drawer
- Front Riser
- Independent Riser

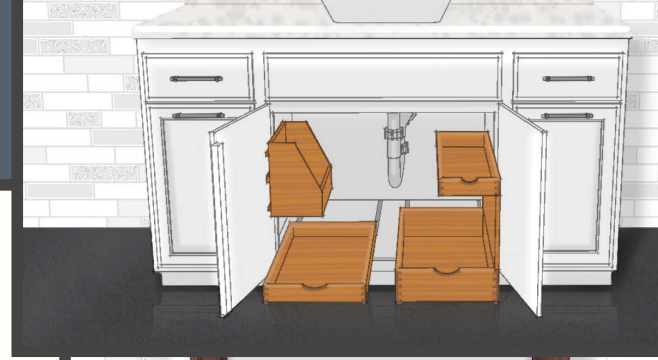

Cookbook & Magazines

Keep magazines & cookbooks off of your counters by using our convenient, sloped Pull Out Solutions.

- Sloped Cookbook Solution

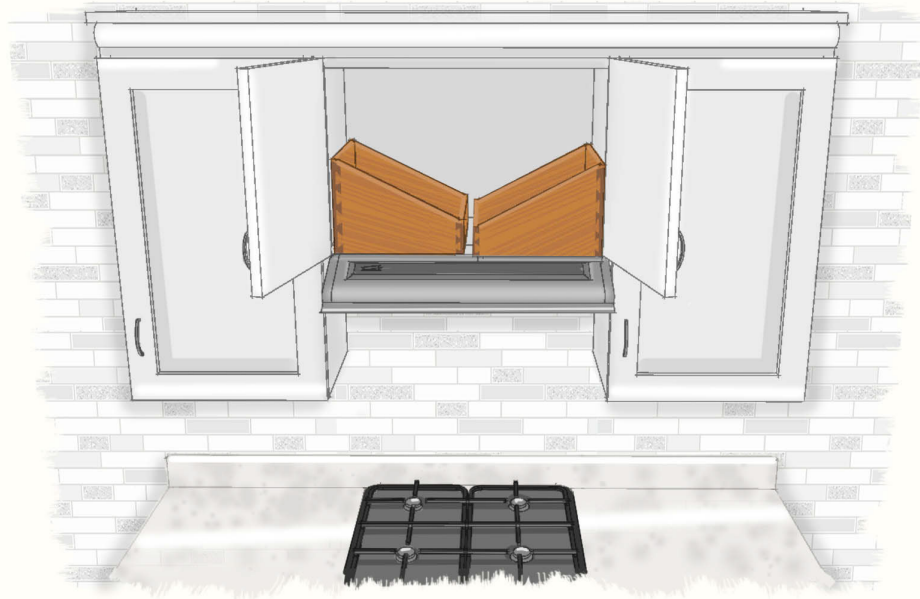



Pantry Solutions

The pantry can be one of the most used and unorganized areas of your kitchen. Our expertly crafted drawers can fit into any pantry, transforming an area of clutter and stress into a place of joy and ease. Our custom sizes allow for even the bulkiest of items to be safely and conveniently organized. Art Of Drawers' custom designed solutions are the perfect way to make the most of your pantry.



MORE SOLUTIONS

Accessories

*“A place for everything and
everything in its place.”*

- Isabella Beeton



Drawer Insert

Maple hardwood drawer insert with compartments to store your kitchen cutlery. This tray blends perfectly with any cabinet and can be customized to fit drawers of various dimensions.

Tip Out Tray

Wasted space is a thing of the past with the addition of our deluxe molded sink front trays. These stainless steel tip-out trays add a touch of elegance in a small area that is normally wasted.





Spice Solutions

Wood Spice Rack

Preserve shelf space and keep spices within reach with this wooden door-mounting spice rack. Constructed from attractive maple hardwood, this storage saver is available for 15", 18" and 21" wall cabinets.

Wood Spice Drawer Insert

Keep spices close at hand with this hardwood spice drawer insert. A tiered design lets you easily reach your spices when cooking and keeps them organized the rest of the time. With beautiful maple construction, this drawer insert is sure to complement any cabinet.



Pull Out Organizers

This solid wood pull-out system features shelves with chrome rails and a technologically advanced three-slide system for complete stability. Shelves are adjustable and allow you to create up to four storage surfaces, maximizing your available space. Door mounting brackets are included for safe and easy installation.





Pull Down Organizers

Tired of dragging the dining room chair into the kitchen to reach everything in your upper cabinet? With this revolutionary pull-down shelving system, all of the items in your cabinet are within easy reach. Chrome-plated shelves give your kitchen an elegant modern allure, while a unique gas-assisted lifting and lowering mechanism provides unparalleled stability throughout its full range of motion.

Corner Cabinets

Lazy Susans allow for maximum visibility in any cabinet from a standard base to that blind corner unit that you never know what to do with. No more missing cans or boxes! For those that demand the best, Art of Drawers is proud to offer its furniture-grade Natural Wood D-Shape Susans. These two shelf sets are available in 20", 28" and 32" diameters. Each comes standard with Chrome Hardware and features a solid maple steam bent rim.

- D-Shaped Lazy Susan
- Wood Pie Lazy Susan





Blind Corner Cabinets

Blind corner cabinets don't have to be wasted space and lost items. Our solutions offer increased shelf space and optional soft-close. We are bringing more functionality and accessibility out of your cabinets. These solutions fit into nearly all blind corner applications, and its chrome rails and solid maple shelving make it an attractive addition to any kitchen. So ease your knees, back and stress levels and elevate your kitchen storage to the cloud.

Drawer in a Drawer

The Drawer in a Drawer pull out is a combination of two drawers in one unit. This drawer within a drawer combination uses a “click to open” side mount rail for the inner drawer. When the inner drawer is opened, it slides back towards the cabinet to reveal the drawer beneath it. It is ideal for utility and cutlery items while the drawer space beneath is ideal for bigger items such as pots and lids.





Waste | Recycle

Spare yourself and your guests from unsightly garbage and recycle bins in the kitchen. With our helpful solutions, Art of Drawers is able to tuck these containers away, while still keeping them accessible for easy use.

- Trash | Recycling Drawer



OUR SOLUTION

Materials

We begin by carefully selecting our materials from a broad selection of high-quality woods. We use durable under-mount rails from Blum, providing you with smooth, easy movements. Our finishing materials used to handcraft your drawers are water soluble, toxin-free and deliver a finish that showcases the clarity and beauty of your new custom drawers.

Most popular wood species



9-Ply Baltic Birch - This economical plywood is unlike plywood you may be used to seeing, with an all birch veneer core, giving it increased strength and stability.

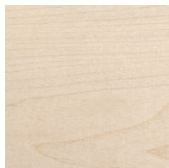

Soft Maple - This beautiful hard wood is rich, light, and features a well balanced wood grain. Its color ranges from pale brown to almost white with highlights of brown.



Natural Maple - Generally straight-grained with a consistent texture, maple also can have a bird's-eye or curly (also called fiddle back) pattern. Its unique color, smooth grain, and strength making natural maple a popular choice for those wanting to add extra character to their masterpiece.



Most popular wood species

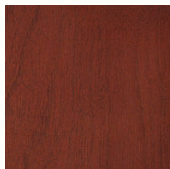

Cherry - Strong and regal in color, the heartwood of cherry varies from rich red to reddish brown, and it deepens to its characteristic reddish brown with age and exposure to light. Cherry wood has a straight, satiny grain, often with a ripple figure. Heavy and hard, stiff and strong, the wood is durable and great for everyday use.

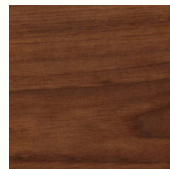

Walnut - One of the most enjoyed American hardwoods for its fine-yet-open grain, unique patterns, and bold dark color, walnut is a handsome wood. Walnut trees often bear knots and burls, that produce tightly swirling patterns full of charisma and grace.

The Art of Gliding

We think working in the kitchen should be a well-coordinated dance. Movements should be easy and fluid, and cabinets should open with a light pull of the handle and close softly and effortlessly. Art of Drawers' partnership with Blum, the world's leading manufacturers of drawer slides, gives us over 50 years of smooth gliding experience.

BLUMOTION

by Blum



We exclusively use undermount Blum Tandem and Movento Blumotion® drawer runners. Designed to allow effortless and easy access to find what you need at a glance, your slides can handle anything you throw at them - even up to 150 pounds! Our durable under-mount rails allow for drawers

to be opened with a light touch and close quietly. Since the runners are concealed under the drawer, they never interfere with those beautiful dovetail details. Our partnership with Blum guarantees a lifetime of joy every time you open your drawers.

FORM & FUNCTION

Upgrades

“Successful organizing is based on the recognition that people get organized because they, too, have a vision.” -Paul Wellstone

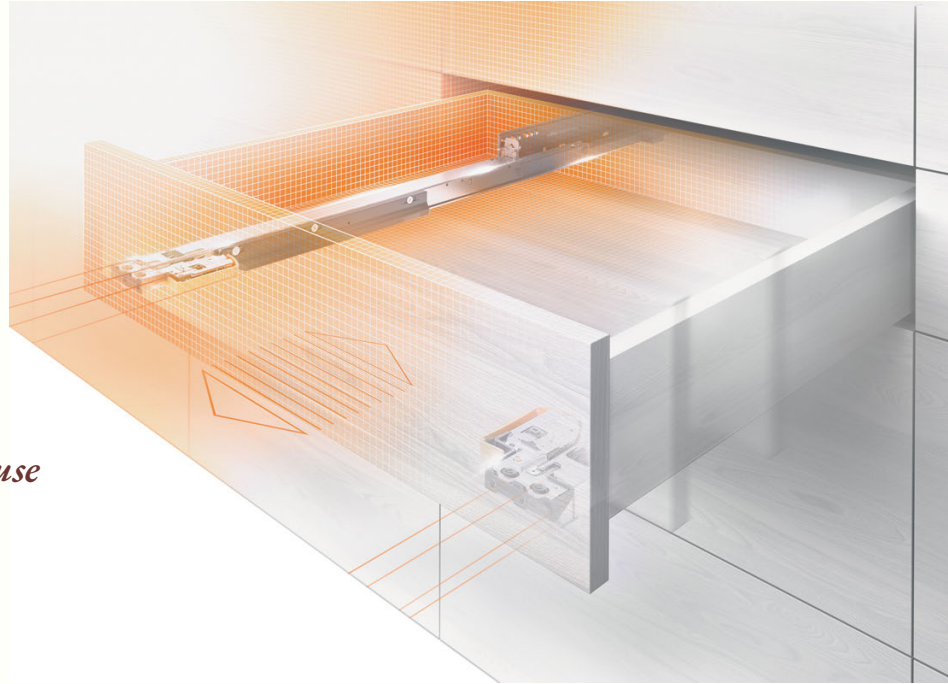

Upgrades

Slopes - Slopes offer further pull out customization. Slopes prevent tall items from tipping when stored in the back of the pull out drawer. A common location for a sloped drawer is in the upper portion of a pantry.

Scoops - Scoops provide a beautiful designer touch to your drawers. In addition, the scoop provides a handle to effortlessly pull out drawers in spaces with a small amount of height clearance.

Dividers - Don't let anything get in the way of staying organized. Our custom dividers allow you get into the groove and put everything in its place.

Slope Options

Diagonal Partial Side Taper

This box is typically used as a pullout drawer. It has a higher back that is partially tapered on each side to a lower front.



Range Box Side Scallop

This box is typically used as a cooking range drawer. It has a lower back that is scalloped up on each side to a higher front.





Style A



Style B



Style C

Scoop Options

Scoops provide a beautiful designer touch to your drawers. In addition, the scoop provides a handle to effortlessly pull out drawers in spaces with a small amount of height clearance.

THE ART OF DRAWERS

Experience

“Simplicity is the ultimate sophistication.”

-Leonardo Da Vinci





DOVETAILS

The dovetail is symbolic of fine woodworking.

There is simply no stronger or prettier way to join the sides of a Drawer, which will be pulled in and out thousands of times in its life. There are two parts to a dovetail joint, pins and tails. The tails look like the tails of doves (hence the name), and the pins are on the opposite board and fit in between the tails to create a joint that is impossible to pull apart.

LIFETIME PROTECTION

All of our products come with a Lifetime Warranty, ensuring your drawers will be around for the long haul.

ENVIRONMENTALLY FRIENDLY

Our drawers are designed as Green products and are built with a focus on ecologically friendly materials and environmental stewardship. With our eco-friendly designs, you can have both healthy *and* attractive drawers. Our finishes resists scratches, chips and the effects of solvent wipe down. All of our woods are responsibly harvested from well-managed forests.





AMERICAN MADE

We are proud that all of our custom products are Made in America.

100% ELATION GUARANTEE™

We are so confident you will fall in love with your Art of Drawers solutions, we are willing to bet on it. If you are not completely elated with 3 days of installation, we will remove and refund your entire purchase.



ARTOFDRAWERS.COM | 888-559-9069